

**G Connectors**

Specifications	87
Flexible Cable	88
Bulkhead	89
PCB Mount	90
In Series Adapters	91

Other Information

Assembly Instructions	176
Cable Assembly	166
Cable Information	168
Numerical Index	184

Prices, specifications, statement of warranty, and other terms and conditions are subject to change without notice by Lighthouse Technologies, Inc.



G series connectors provide consistent electrical performance at 75 ohms impedance. They accommodate .022" to .042" center conductor sizes producing low insertion and high withdrawal forces. Type G receptacles are used in today's 1 GHz amplifier and fiber optic node equipment designs. Lighthouse Technologies also offers a 15 amp G receptacle for use in the new generation of amplifier and fiber optic node equipment for HFC networks. Other applications for the G series connectors include telecommunications and CATV MSOs.

ELECTRICAL RATINGS

Impedance	50 ohm
Frequency Range	0-1 GHz
RF Leakage	-100 dB min @ 1 GHz

MECHANICAL & ENVIRONMENTAL RATINGS

Mating	3/8-24 UNEF threaded coupling
Durability	500 matings
Vibration, Mechanical Shock, Corrosion, Thermal Shock	All connectors comply with MIL-STD 202 specification
Temperature Range	-40°C to + 140°C

MATERIALS

		<i>Material</i>	<i>Plating</i>
Connector Body		Brass per QQ-B-626	Nickel, Bright Acid Tin
Center Contact	<i>Male</i>	Brass per QQ-B-626	Nickel, Tin
	<i>Female</i>	Beryllium Copper per QQ-C-530	Bright Acid Tin
Insulator		Teflon, Polypropylene, Delrin	None
Crimp Ferrule		Annealed Copper per WW-T-799	Same as body



Straight Crimp Plug

Part Number	Cable Type
LTI-GSM11NT-XXX	RG-316,174,188;Q1,D316
LTI-7GSM11NT-179	RG-179 (75 ohm)

TO CREATE COMPLETE PART NUMBER:
Fill in Cable Type where XXX is.
See Part Numbering Chart on page 3 for more info.

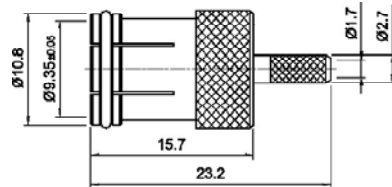

ASSEMBLY INST.: Page 176
Recommended Stripping DIMS:
Page 172, Line 40

Bulkhead Crimp Plug

Part Number	Cable Type
LTI-GSM13FNT-XXX	RG-316,174,188;Q1,D316
LTI-7GSM13FNT-179	RG-179 (75 ohm)

TO CREATE COMPLETE PART NUMBER:
Fill in Cable Type where XXX is.
See Part Numbering Chart on page 3 for more info.

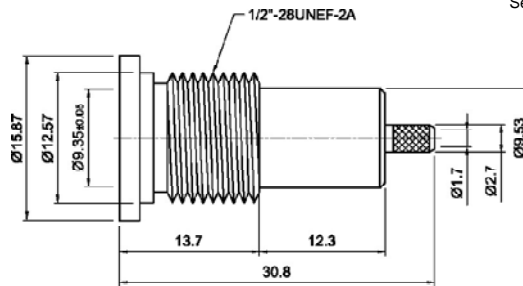

ASSEMBLY INST.: Page 176
Recommended Stripping DIMS:
Page 172, Line 40

Straight Crimp Jack

Part Number	Cable Type
LTI-GSF11NT-XXX	RG-316,174,188;Q1,D316
LTI-7GSF11NT-179	RG-179 (75 ohm)

TO CREATE COMPLETE PART NUMBER:
Fill in Cable Type where XXX is.
See Part Numbering Chart on page 3 for more info.

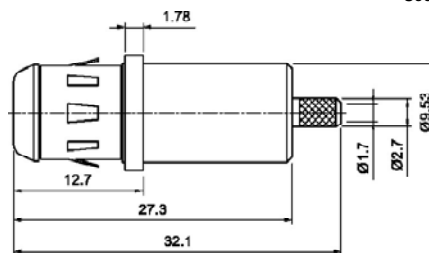

ASSEMBLY INST.: Page 176
Recommended Stripping DIMS:
Page 172, Line 40



Front Mount Bulkhead Jack with Tab Terminal

Part Number	M.H.
LTI-GSF73BTP	7

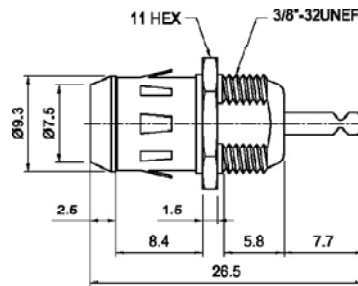

MOUNTING HOLE (M.H.): Page 174

Front Mount Bulkhead Jack with Solder Post

Part Number	M.H.
LTI-GSF93BTP	7

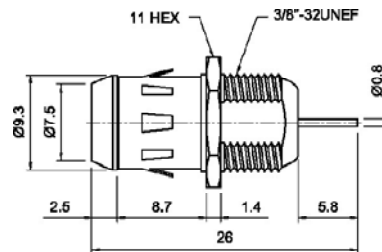

MOUNTING HOLE (M.H.): Page 174

Front Mount Bulkhead Jack with Solder Post

(**15 amp version**)

Part Number	M.H.
LTI-GSF93BTP-15AMP	7

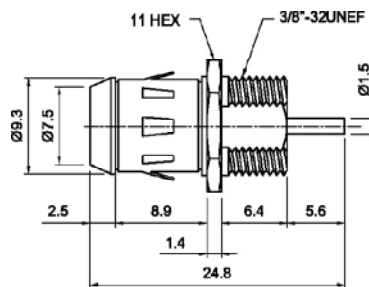

MOUNTING HOLE (M.H.): Page 174



Vertical PCB Thru Hole Plug

Part Number	M.H.
LTI-GSM54BTP	29

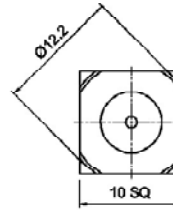
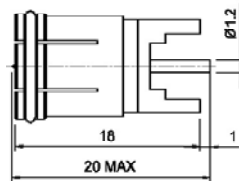

MOUNTING HOLE (M.H.): Page 174

Vertical PCB Thru Hole Jack

Part Number	M.H.
LTI-GSF54BTP	28

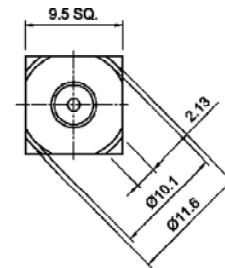
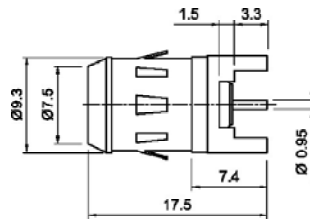

MOUNTING HOLE (M.H.): Page 174

Vertical PCB Bulkhead Thru Hole Jack

Part Number	M.H.
LTI-GSF543BTP	30

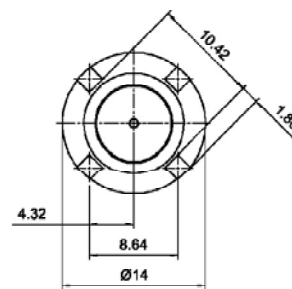
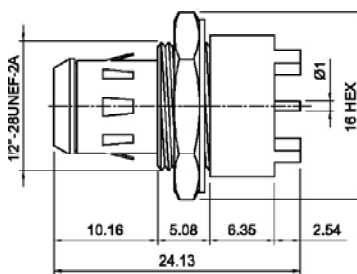

MOUNTING HOLE (M.H.): Page 174



Adapter, Plug to Plug

Part Number
LTI-A2GSMMBTP

